

RUNWAY SAFETY AREA

| | FUTURE 8 | FUTURE 26 | FUTURE 18 | FUTURE 36 |
|--------------------------------------|----------------------------|----------------------------|------------------------|------------------------|
| RUNWAY PROTECTION ZONE (RPZ) | 1,000' x 1,750' x 2,500' | 1,000' x 1,750' x 2,500' | 500' x 700' x 1,000' | 500' x 700' x 1,000' |
| FAR PART-77 APPROACH SURFACE | 1,000' x 16,000' x 50,000' | 1,000' x 16,000' x 50,000' | 500' x 1,500' x 5,000' | 500' x 1,500' x 5,000' |
| RUNWAY SAFETY AREA (RSA) | 1,000' x 500' | 1,000' x 500' | 300' x 150' | 300' x 150' |
| OBJECT FREE AREA (OFA) | 1,000' x 800' | 1,000' x 800' | 300' x 500' | 300' x 500' |
| OBSTACLE FREE ZONE (OFZ) | 200' x 400' | 200' x 400' | 200' x 250' | 200' x 250' |
| PRECISION OBSTACLE FREE ZONE* (POFZ) | 200' x 800' | 200' x 800' | N/A | N/A |

NOTE:
 *THE PRECISION OBSTACLE FREE ZONE IS IN EFFECT ONLY WHEN ALL OF THE FOLLOWING OPERATIONAL CONDITIONS ARE MET:
 1. VERTICAL GUIDED APPROACH
 2. REPORTED CEILING BELOW 250 FEET AND/OR VISIBILITY LESS THAN 3/4 STATUTE MILE (OR RVR BELOW 4,000 FEET)
 3. AN AIRCRAFT ON FINAL APPROACH WITHIN TWO MILES OF THE RUNWAY THRESHOLD

RUNWAY DATA

| | FUTURE 8 | FUTURE 26 | FUTURE 18 | FUTURE 36 |
|----------------------------------|--------------------|--------------------|------------------|------------------|
| LATITUDE (LAT.) | 42° 44' 27.84" N | 42° 44' 39.31" N | 42° 45' 03.92" N | 42° 44' 29.48" N |
| LONGITUDE (LONG.) | 86° 07' 14.34" W | 86° 05' 48.61" W | 86° 06' 00.97" W | 86° 05' 56.77" W |
| ELEVATION (EL.) | 698' | 686' | 672' | 672' |
| STATION (STA.) | 67+02 | 02+00 | 100+00 | 135+00 |
| BEARING | N 79° 42' 18.36" E | N 79° 42' 18.36" E | N 174° 51' 38" E | N 174° 51' 38" E |
| APPROACH TYPE | PRECISION | PRECISION | VISUAL | VISUAL |
| TOUCHDOWN ZONE LATITUDE (LAT.) | 42° 44' 27.84" N | 42° 44' 39.31" N | 42° 45' 03.92" N | 42° 44' 29.48" N |
| TOUCHDOWN ZONE LONGITUDE (LONG.) | 86° 07' 14.34" W | 86° 05' 48.61" W | 86° 06' 00.97" W | 86° 05' 56.77" W |
| TOUCHDOWN ZONE ELEVATION (EL.) | 698' | 686' | 672' | 672' |

APRON DATA

| | EXISTING 1 | EXISTING 2 | EXISTING 3 |
|-------------|-------------|--------------|--------------|
| DESCRIPTION | HOLD APRON | HANGAR APRON | HANGAR APRON |
| SIZE | 260' x 270' | 676' x 278' | 350' x 148' |

DIMENSIONAL INFORMATION

| | FUTURE 8 | FUTURE 26 | FUTURE 18 | FUTURE 36 |
|---|-----------|-----------|-----------|-----------|
| RUNWAY LENGTH | 6,502' | 6,502' | 3,500' | 3,500' |
| RUNWAY WIDTH | 100' | 100' | 75' | 75' |
| RUNWAY SHOULDER WIDTH | 0' | 0' | 0' | 0' |
| TAXIWAY WIDTH | VARIABLES | VARIABLES | VARIABLES | VARIABLES |
| TAXIWAY EDGE SAFETY MARGIN | 7.5' | 7.5' | 7.5' | 7.5' |
| TAXIWAY SHOULDER WIDTH | 0' | 0' | 0' | 0' |
| TAXIWAY SAFETY AREA WIDTH | 79' | 79' | 79' | 79' |
| TAXIWAY OBJECT FREE AREA WIDTH | 131' | 131' | 131' | 131' |
| RUNWAY CENTERLINE TO TAXIWAY HOLD LINE | 250' | 250' | 250' | 250' |
| RUNWAY CENTERLINE TO BUILDING RESTRICTION LINE LENGTH | 745' | 745' | 495' | 495' |

BUILDING DATA TABLE

| STRUCTURE | DESCRIPTION | HEIGHT - AGL | TOP ELEVATION - MSL |
|-----------|-------------------------|--------------|---------------------|
| (A) | TUNNEL CONTROL | 15.5' | 698' |
| (B) | TO BE REMOVED | 10' | 704' |
| (C) | CORPORATE HANGAR | 24.5' | 706' |
| (D) | FBO MAINTENANCE HANGAR | 29' | 709' |
| (E) | TENANT COMMUNITY HANGAR | 23' | 702' |
| (F) | TENANT OFFICE BUILDING | 16' | 694' |
| (G) | TENANT COMMUNITY HANGAR | 40.5' | 718' |
| (H) | ELECTRICAL VAULT | 10' | 686' |
| (I) | BOX HANGAR | 30' | 706' |
| (J) | T-HANGARS (8 UNIT) | 18.5' | 693' |
| (K) | T-HANGARS (8 UNIT) | 18.5' | 692' |
| (L) | T-HANGARS (8 UNIT) | 18.5' | 692' |
| (M) | TERMINAL / FBO | 25' | 676' |

NOTE:
 AGL = ABOVE GROUND LEVEL
 MSL = MEAN SEA LEVEL

LEGEND

| FUTURE | EXISTING | ITEM |
|--------|----------|--|
| N/A | (Symbol) | BUILDINGS |
| N/A | (Symbol) | TREES AND TREE LINES |
| N/A | (Symbol) | FENCE LINES |
| N/A | (Symbol) | ROADS |
| N/A | (Symbol) | RAILROAD |
| N/A | (Symbol) | WETLANDS |
| N/A | (Symbol) | RIVERS, LAKES, COUNTY DRAINS |
| N/A | (Symbol) | GROUND CONTOURS |
| N/A | (Symbol) | WIND CONE |
| N/A | (Symbol) | ROTATING BEACON |
| N/A | (Symbol) | RUNWAY / TAXIWAY LIGHTING |
| N/A | (Symbol) | POWER POLE |
| N/A | (Symbol) | ANTENNA TOWER |
| N/A | (Symbol) | AIRPORT PROPERTY LINE |
| N/A | (Symbol) | PROPERTY ACQUISITION - FEE |
| N/A | (Symbol) | PROPERTY PARCELS |
| N/A | (Symbol) | SECTION LINES |
| N/A | (Symbol) | AVIGATION EASEMENT |
| N/A | (Symbol) | LAND RELEASE |
| N/A | (Symbol) | RUNWAYS, TAXIWAYS, PARKING TO BE REMOVED |
| N/A | (Symbol) | RUNWAY MARKINGS |
| N/A | (Symbol) | CENTERLINES |
| N/A | (Symbol) | RUNWAY PROTECTION ZONE |
| N/A | (Symbol) | RUNWAY SAFETY AREA |
| N/A | (Symbol) | OBJECT FREE AREA |
| N/A | (Symbol) | OBSTACLE FREE ZONE |
| N/A | (Symbol) | BUILDING RESTRICTION LINE |
| N/A | (Symbol) | APPROACH SURFACE |
| N/A | (Symbol) | TAXIWAY OBJECT FREE AREA |
| N/A | (Symbol) | RUNWAY VISIBILITY ZONE |

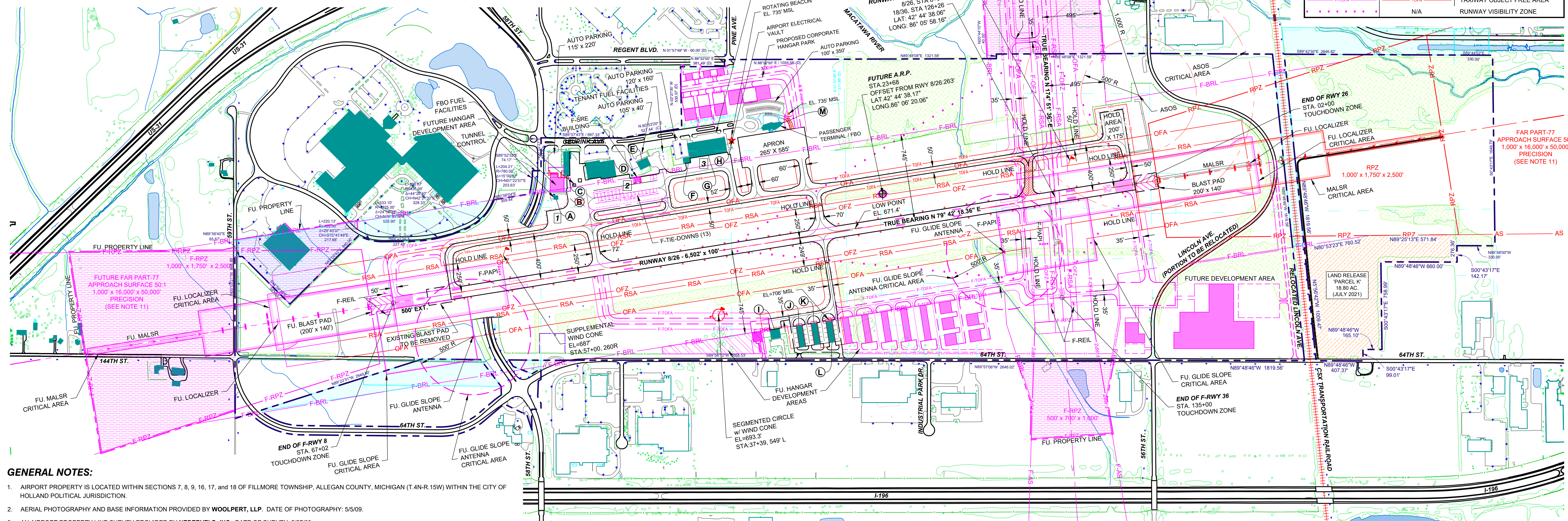

GENERAL NOTES:

- AIRPORT PROPERTY IS LOCATED WITHIN SECTIONS 7, 8, 9, 16, 17, AND 18 OF FILLMORE TOWNSHIP, ALLEGAN COUNTY, MICHIGAN (T.4N.15W) WITHIN THE CITY OF HOLLAND POLITICAL JURISDICTION.
- AERIAL PHOTOGRAPHY AND BASE INFORMATION PROVIDED BY WOOLPERT, LLP. DATE OF PHOTOGRAPHY: 5/5/09.
- AIRPORT PROPERTY LINE SURVEY PROVIDED BY NEDERVELD, INC. DATE OF SURVEY: 5/27/09.
- THE NORTH MAGNETIC DECLINATION WAS CALCULATED USING INFORMATION FOUND ON WWW.NGDC.NOAA.GOV/SEG/GEOMAG/DECLINATION. THESE CALCULATED FIGURES ARE BASED ON THE INTERNATIONAL GEOMAGNETIC REFERENCE FIELD MODEL, VERSION 10 (2005-2010). DECLINATION AND VARIANCE CALCULATED: 05/26/11.
- THE AIRPORT IS CLASSIFIED AS AN AIRPLANE DESIGN GROUP II; HOWEVER, SEVERAL TAXIWAYS ARE CONSTRUCTED USING AIRPLANE DESIGN GROUP III STANDARDS.
- CONTACT "MISS DIG" PRIOR TO ANY CONSTRUCTION TO DETERMINE THE LOCATION OF BELOW GROUND UTILITIES.
- MORE DETAILED EXISTING BUILDING INFORMATION IS SHOWN ON BUILDING AREA PLAN, SHEET 6.
- HEIGHT OF PERIMETER FENCE VARIES AND SHOULD BE CONFIRMED WITH AIRPORT SPONSOR REGARDING HEIGHTS AT SPECIFIC LOCATIONS.
- THE SYMBOLS SHOWN ARE SMALL DUE TO SCALE; HOWEVER, THEY ARE LEGIBLE IN THE ELECTRONIC FILE.
- ALL FUTURE HOLD LINES ARE OFFSET FROM THE RUNWAY 8/26 250' UNLESS OTHERWISE NOTED.
- THE EXISTING RUNWAY 26 AND FUTURE RUNWAY 8 APPROACH SURFACE SLOPE IS 50:1 FOR THE FIRST 10,000 FT. AND THEN 40:1 FOR THE FINAL 40,000 FT.

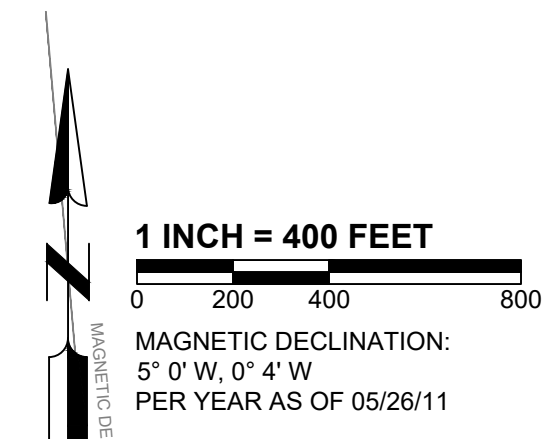

REVISIONS

| NO. | DATE | REMARKS | BY | CHK |
|-----|----------|---|-----|-----|
| 1 | 10/26/15 | ADDED PARCEL 37, UPDATED RWAY 8 RPZ | AEF | AEF |
| 2 | 2/22/17 | FM 03-07-C28 | GAM | AEF |
| 3 | 5/2/18 | ADDED FUTURE LAND RELEASE | AEF | AEF |
| 4 | 10/10/18 | EAST APRON TAXIWAY CONNECTOR | AEF | JET |
| 5 | 01/21 | PEN & INK CHANGE FOR PROPOSED HANGAR | AEF | JET |
| 6 | 8/21 | PEN & INK CHANGE PROPOSED CORPORATE HANGAR PARK | AEF | JET |
| 7 | 1/22 | ADDED LAND RELEASE PARCEL K | AEF | AEF |
| 8 | 3/26 | ADDED FUTURE SRE BUILDING AND TIE-DOWNS | AEF | JET |

WEST MICHIGAN REGIONAL AIRPORT
 HOLLAND, MI

AIRPORT LAYOUT PLAN
FUTURE AIRPORT LAYOUT PLAN

STATE ID. NO. --- MSH PROJECT NO. --- 08199-00-00001
 FEDERAL CONTRACT NO. --- 000
 STATE CONTRACT NO. --- B-26-0045-3006

DESIGNED: SAOW 5/11
 DRAWN: AEF 5/11
 CHECKED: SAOW 5/11

03-07

2655 PORT LANSING ROAD
 LANSING, MICHIGAN 48208
 517.321.8334 - 517.321.5932 FAX

Mead & Hunt

These documents shall not be used for any purpose or project for which it is not intended. Mead & Hunt shall be indemnified by the client and held harmless from all claims, damages, liabilities, losses, and expenses, including attorney's fees and costs, arising out of such use or reuse of the documents, in addition to unauthorized reproduction of these documents, in part or as a whole, is prohibited.

4 OF 14

March 15, 2009 - 10:07 Title City Airport ALP.dwg